

Heat shrinkable busbar insulation tubing
高壓銅排熱收縮套管



HB
Heat shrinkable busbar insulation tubing

Applications

Provides high resistance to tracking and arching and used to enhance the insulation properties of bus-bar in switchgear and substation. The continuous length of supplied products makes it to be used more conveniently and economically.

Characteristics

- Flexible and flame resistant
- Easy and fast installation
- Excellent chemical resistance and insulation performance

Operating temperature range

- Operating temperature: 125°C
- Minimum shrink temperature: 125°C
- Minimum full recovery temperature: 135°C

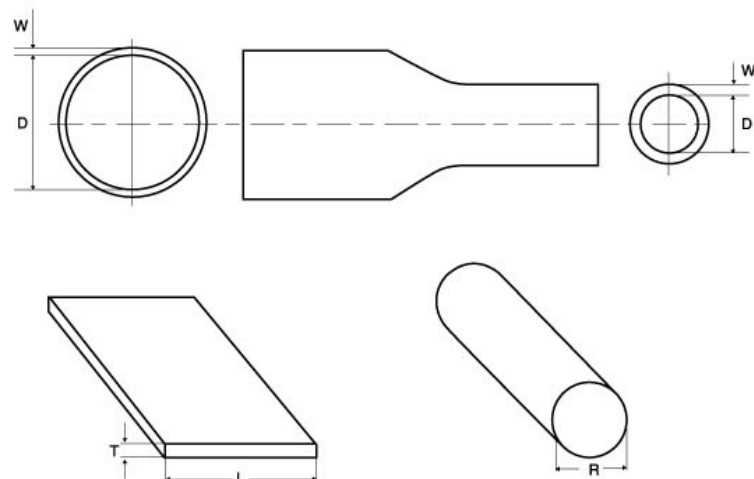

Product dimensions (mm) HB1/FOR 3.6 KV

type	as supplied (mm)		after recovered (mm)		applicable busbar dimensions (mm)	
	ID (D)	WT (W)	ID (D)	WT(W)	L+T (Min) (Max)	R (Min) (Max)
30/15	31.5±0.7	0.45±0.15	15	0.9±0.15	22~38	13.5~25
40/20	41.5±0.7	0.50±0.15	20	1.0±0.15	25~40	16~30
50/25	51.5±0.7	0.50±0.15	25	1.0±0.15	36~65	22~43
60/30	≥60	0.60±0.15	30	1.55±0.2	38~70	25~50
70/35	≥70	0.70±0.15	35	1.60±0.2	41~80	28~58
80/40	≥80	0.75±0.15	40	1.70±0.2	55~95	33~63
90/45	≥90	0.75±0.15	45	1.90±0.2	70~130	44~86
100/50	≥100	0.80±0.20	50	2.10±0.2	70~130	44~86
120/60	≥120	0.80±0.20	60	2.20±0.2	90~165	55~105
150/75	≥150	0.90±0.20	75	2.20±0.2	MAX	MAX
180/90	≥180	0.95±0.20	90	2.30±0.2	MAX	MAX

Color: Red, Yellow, Blue, Green, White, Black

Product dimensions (mm) HB2/FOR 24 KV

type	as supplied (mm)		after recovered (mm)		applicable busbar dimensions(mm)	
	ID (D)	WT (W)	ID (D)	WT (W)	L+T (Min) (Max)	R (Min) (Max)
20/9	20±0.8	1.0±0.2	9	2.2±0.2	12~18	6.5~12.0
30/9	30±0.8	1.0±0.2	13	2.2±0.2	22~38	13.5~25.0
40/15	40±1	1.2±0.2	15	2.2±0.2	25~40	16~30
50/20	50±2	1.2±0.2	20	2.5±0.2	36~65	22.0~43.0
65/24	65±3	1.2±0.2	24	3.0±0.2	39~62	25~44
80/32	80±3	1.2±0.3	32	3.0±0.3	55~95	33.0~63.0
100/40	100±4	1.2±0.3	40	3.0±0.3	70~130	44.0~86.0
120/48	120±4	1.2±0.3	48	3.0±0.3	90~165	55.0~105.0
150/61	150±4	1.2±0.3	61	3.5±0.3	95~138	60~100
180/61	180±5	1.2±0.3	61	3.5±0.3	MAX	MAX
210/80	210±5	1.2±0.3	80	3.5±0.3	MAX	MAX

Color: Red

Product dimensions (mm) HB3/FOR 36 KV

type	as supplied (mm)		after recovered (mm)		applicable busbar dimensions (mm)	
	ID (D)	WT (W)	ID (D)	WT (W)	L+T (Min) (Max)	R (Min) (Max)
30	30±1.0	2.0±0.3	13	4.0±0.3	22~38	13.5~25.0
40	40±1.0	2.0±0.3	15	4.0±0.3	25~40	16~30
50	50±2.0	2.2±0.3	20	4.5±0.3	36~65	22.0~43.0
65	65±2.0	2.2±0.3	24	4.5±0.3	39~62	25~44
80	80±3.0	2.2±0.3	32	4.5±0.3	55~95	33.0~63.0
100	100±4.0	2.5±0.3	40	4.5±0.3	70~130	44.0~86.0
120	120±4.00	2.5±0.3	48	5.0±0.3	90~165	55.0~105.0
150	150±4.0	2.5±0.3	60	5.0±0.3	95~138	60~100
180	180±5.0	2.8±0.3	70	5.5±0.3	MAX	MAX
210	210±5.0	2.8±0.3	80	5.5±0.3	MAX	MAX

Color: Red

